

# EROSION CONTROL LINE

TOWN OF NORTH REDINGTON BEACH  
PINELLAS COUNTY, FLORIDA

LEGAL DESCRIPTION

AN EROSION CONTROL LINE, LYING WITHIN THE CORPORATE LIMITS OF THE TOWN OF NORTH REDINGTON BEACH, PINELLAS COUNTY, FLORIDA, IN SECTION 5, TOWNSHIP 31 SOUTH, RANGE 15 EAST, DESCRIBED AS FOLLOWS:

COMMENCING AT THE MOST SOUTHERLY CORNER OF LOT 8, BATH CLUB ESTATES SUBDIVISION, ACCORDING TO PLAT THEREOF, AS RECORDED IN PLAT BOOK 23, PAGES 21 AND 22, OF THE PUBLIC RECORDS OF PINELLAS COUNTY, FLORIDA, SAID CORNER BEING ON THE SOUTH LINE OF THE CORPORATE LIMITS OF SAID TOWN OF NORTH REDINGTON BEACH, AND HAVING A FLORIDA STATE PLANE COORDINATE SYSTEM (WEST ZONE) VALUE OF X=235,180.61, Y=1,265,920.36, RUN ALONG SAID SOUTH CORPORATE LIMIT LINE BY THE FOLLOWING TWO (2) COURSES: N 42°49'07" W, 120.00 FT. ALONG THE WEST LINE OF SAID LOT 8, S 48°49'05" W, 385.07 FT.  
 THENCE N 44°33'10" W, 679.76 FT.; THENCE N 40°14'37" W, 400.31 FT.; THENCE N 42°25'33" W, 700.00 FT. FOR A POINT OF BEGINNING, SAID POINT HAVING FLORIDA STATE PLANE COORDINATE SYSTEM (WEST ZONE) VALUE OF X=233,601.47, Y=1,267,061.49; THENCE N 39°43'26" W, 300.35 FT.; THENCE N 42°21'21" W, 400.23 FT.; THENCE N 40°04'10" W, 200.00 FT.; THENCE N 39°35'38" W, 500.00 FT.; THENCE N 39°50'25" W, 200.00 FT. FOR A POINT OF ENDING, SAID POINT HAVING FLORIDA STATE PLANE COORDINATE SYSTEM (WEST ZONE) VALUE OF X=232,564.33, Y=1,268,280.17; THENCE CONTINUE N 39°50'25" W, 747.05 FT. TO A POINT OF INTERSECTION WITH THE NORTH LINE OF THE CORPORATE LIMITS OF SAID TOWN OF NORTH REDINGTON BEACH FOR A POINT, SAID POINT HAVING FLORIDA STATE PLANE COORDINATE SYSTEM (WEST ZONE) VALUE OF X=232,085.74, Y=1,268,853.78; THENCE N 88°24'43" E, 689.08 FT. ALONG SAID NORTH CORPORATE LIMIT LINE, SAID LINE ALSO BEING NORTH LINE OF GOVERNMENT LOT 1, TO A POINT OF INTERSECTION WITH THE SOUTH LINE OF GAY SHORES SUBDIVISION; THENCE N 74°39'03" E, 3.02 FT. ALONG SAID SOUTH LINE TO THE SOUTHWEST CORNER OF LOT 8, GAY SHORES SUBDIVISION, ACCORDING TO PLAT THEREOF, AS RECORDED IN PLAT BOOK 25, PAGE 64, OF THE PUBLIC RECORDS OF PINELLAS COUNTY, FLORIDA, FOR A POINT OF REFERENCE, SAID POINT HAVING FLORIDA STATE PLANE COORDINATE SYSTEM (WEST ZONE) VALUE OF X=232,777.46, Y=1,268,873.68.

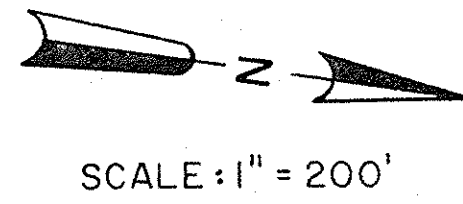

SCALE: 1" = 200'

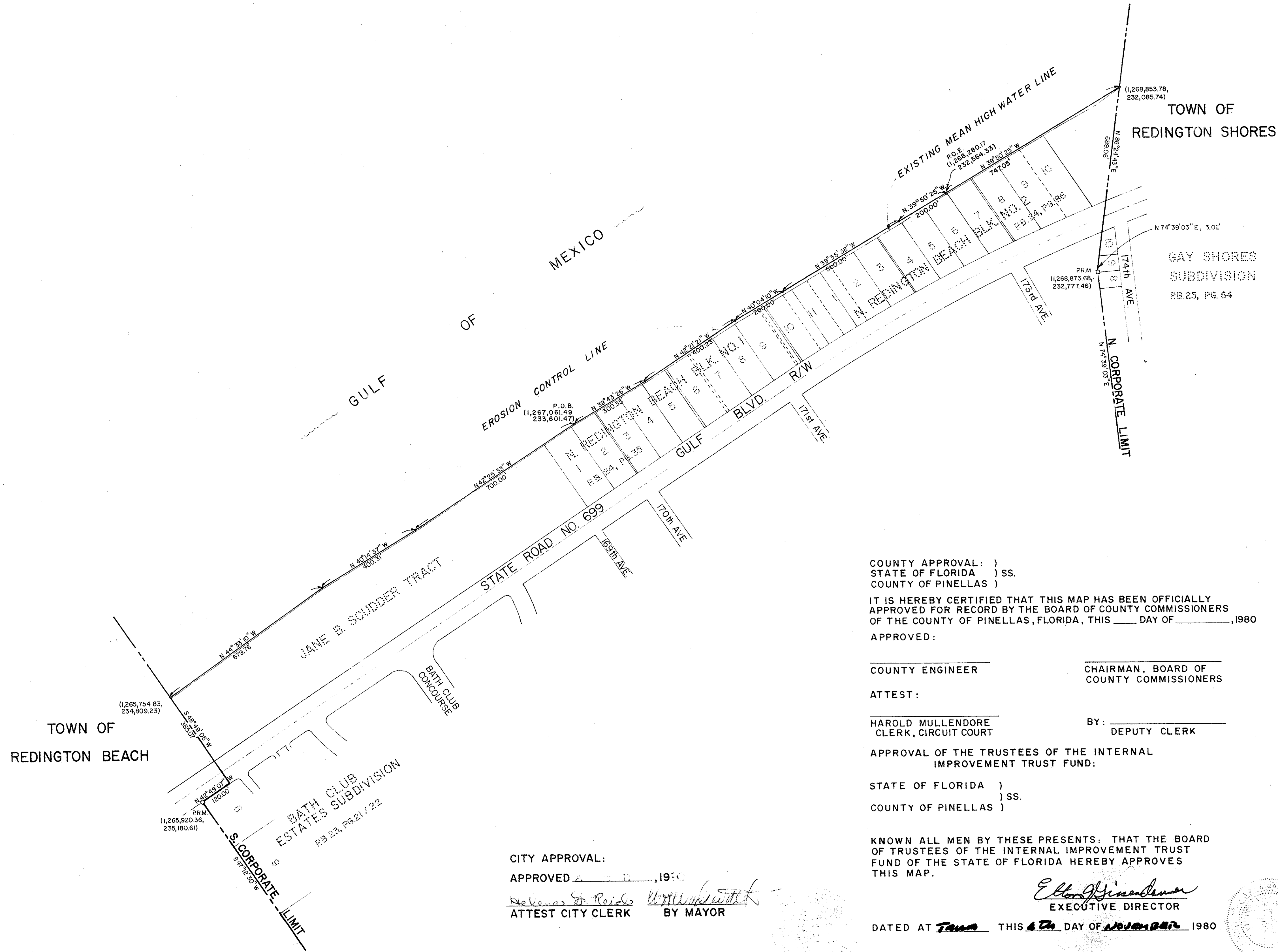

COUNTY APPROVAL: )  
 STATE OF FLORIDA ) SS.  
 COUNTY OF PINELLAS )  
 IT IS HEREBY CERTIFIED THAT THIS MAP HAS BEEN OFFICIALLY APPROVED FOR RECORD BY THE BOARD OF COUNTY COMMISSIONERS OF THE COUNTY OF PINELLAS, FLORIDA, THIS \_\_\_\_ DAY OF \_\_\_\_\_, 1980  
 APPROVED:

COUNTY ENGINEER \_\_\_\_\_ CHAIRMAN, BOARD OF COUNTY COMMISSIONERS \_\_\_\_\_

ATTEST: HAROLD MULLENDORE, CLERK, CIRCUIT COURT BY: \_\_\_\_\_ DEPUTY CLERK

APPROVAL OF THE TRUSTEES OF THE INTERNAL IMPROVEMENT TRUST FUND:

STATE OF FLORIDA )  
 COUNTY OF PINELLAS )

KNOWN ALL MEN BY THESE PRESENTS: THAT THE BOARD OF TRUSTEES OF THE INTERNAL IMPROVEMENT TRUST FUND OF THE STATE OF FLORIDA HEREBY APPROVES THIS MAP.

EXECUTIVE DIRECTOR \_\_\_\_\_  
 DATED AT Tampa THIS 4th DAY OF NOVEMBER 1980

CITY APPROVAL:  
 APPROVED \_\_\_\_\_, 1980  
 ATTEST CITY CLERK \_\_\_\_\_ BY MAYOR \_\_\_\_\_

NOTES  
 BEARINGS, DISTANCES, AND COORDINATES REFER TO STATE GRID SYSTEM WEST ZONE OF FLORIDA.  
 MEAN HIGH WATER WAS ESTABLISHED IN ACCORDANCE WITH CHAPTER 177.25 - 40, F.S., F.A.C. 16-3.  
 THE EROSION CONTROL LINE WAS ESTABLISHED IN ACCORDANCE WITH CHAPTER 161.151 - 161.211 F.S.

CERTIFICATION  
 I, CHARLES C. DIGGES, JR., HEREBY CERTIFY THAT THIS MAP COMPLIES WITH THE REQUIREMENTS OF CHAPTER 177.25 - 177.40 F.S. AND IS CORRECT TO THE BEST OF MY KNOWLEDGE AND BELIEF.  
 \_\_\_\_\_  
 CHARLES C. DIGGES, JR., P.L.S.  
 FLA. SURVEYOR REG. NO. 1442  
 PINELLAS COUNTY ENGINEERING DEPARTMENT  
 PINELLAS COUNTY, FLORIDA.  
 DATE Sept. 30, 1980

584